

Project Management Initials: Designer: DC
Latest Revision Initials: Checked: 60589004
Project Reference Number: 60589004

Last saved by: HATONCM(2022-11-07) Last Plotted: 2022-11-07
Filename: \\NA.AECOM\NET\COM\FS\EN\EA\ST\ALBANS\UNST\1\LEGACY\0\PROJECTS\SUNNICA ENERGY FARMES APPLICATION\CA\DTROS2.WP1\TRAFFIC REGULATION MEASURES_SHEETS_TRC.DWG

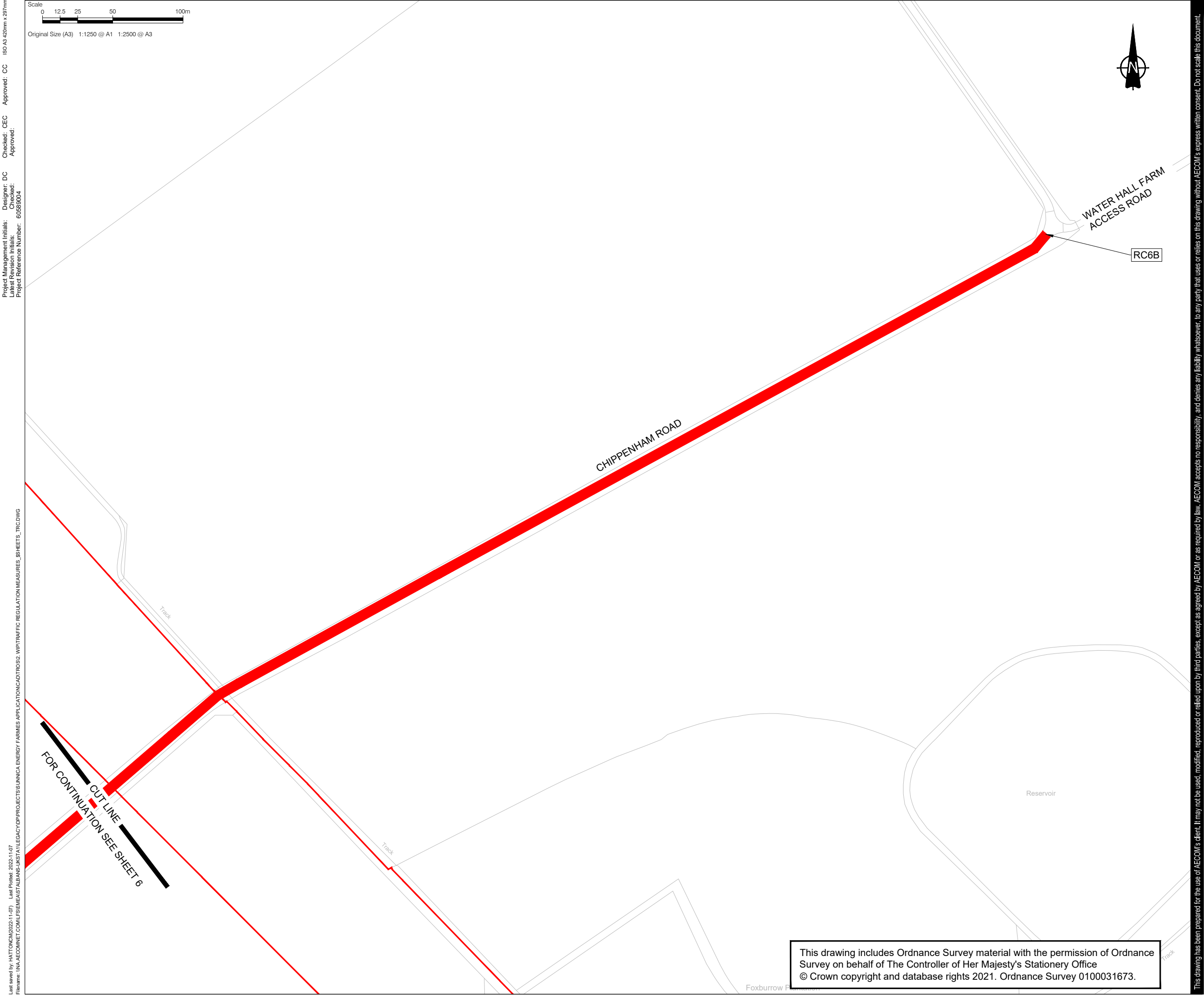

This drawing includes Ordnance Survey material with the permission of Ordnance Survey on behalf of The Controller of Her Majesty's Stationery Office
© Crown copyright and database rights 2021. Ordnance Survey 0100031673.



CONSULTANT

AECOM House, 63-77 Victoria Street,
St. Albans, Hertfordshire, AL1 3ER
+44(0)1727 535000 tel
+44(0)1727 535099 fax
www.aecom.com

PROJECT

Sunnica Energy Farm

CLIENT



NOTE

1. THE TRAFFIC REGULATION MEASURES PLANS SHOULD BE READ IN CONJUNCTION WITH THE DEVELOPMENT CONSENT ORDER AND THE OTHER PLANS AND DOCUMENTS TO BE CERTIFIED BY IT, IN PARTICULAR ARTICLES 11 AND 44 OF, AND SCHEDULES 6 AND 14 TO, THE DEVELOPMENT CONSENT ORDER.
2. FURTHER INFORMATION IN RELATION TO PUBLIC RIGHTS OF WAY AND ACCESSES TO THE AUTHORISED DEVELOPMENT CAN BE FOUND ON THE ACCESS AND RIGHTS OF WAY PLANS.

KEY

- ORDER LIMITS
- PROPOSED TEMPORARY ROAD CLOSURE
- PROPOSED TEMPORARY ROAD CLOSURE (PUBLIC RIGHT OF WAY)

SHEET PLAN

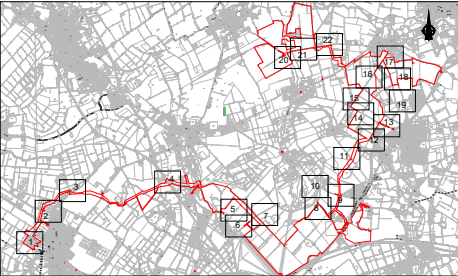

Document Reference: EN010106/APP/2.4

ISSUE/REVISION

2	11/11/2022	SUBMITTED AT DEADLINE 2
1	30/08/2022	CHANGE APPLICATION AUGUST 2022
0	18/11/2021	FOR DCO SUBMISSION
I/R	DATE	DESCRIPTION

SHEET TITLE

TRAFFIC REGULATION MEASURES PLANS -
TEMPORARY ROAD CLOSURES
INFRASTRUCTURE PLANNING
(APPLICATIONS: PRESCRIBED FORMS AND
PROCEDURE) REGULATIONS 2009 5(2)(O)
SHEET 7 OF 22

SHEET NUMBER

60589004-TRM-TRC-007

SCALE

1:2500 @ A3

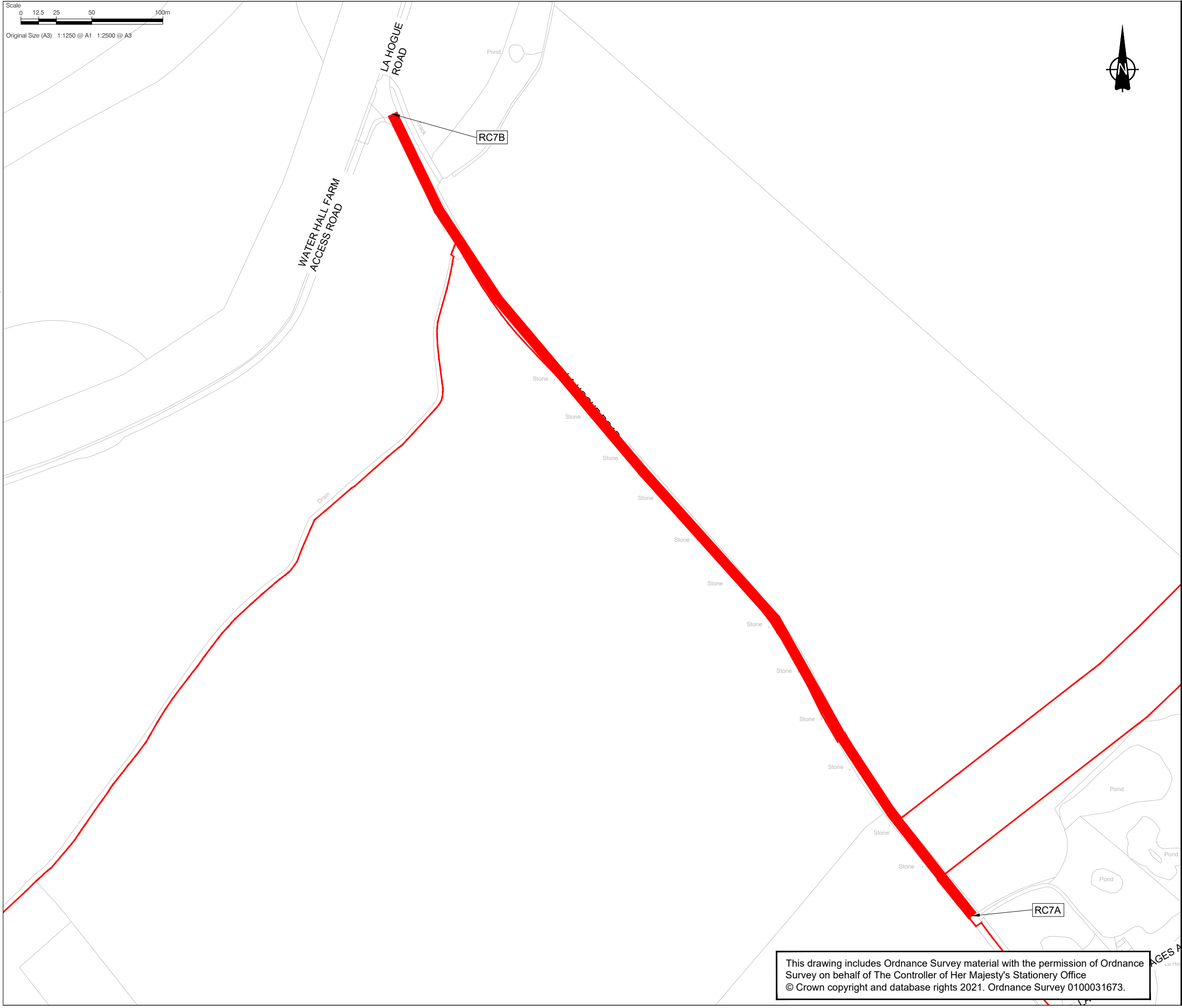

This drawing includes Ordnance Survey material with the permission of Ordnance Survey on behalf of The Controller of Her Majesty's Stationery Office
© Crown copyright and database rights 2021. Ordnance Survey 0100031673.

This drawing has been prepared for the use of AECOM's client. It may not be used, modified, reproduced or relied upon by third parties, except as agreed by AECOM or as required by law. AECOM accepts no responsibility, and denies any liability whatsoever, to any party that uses or relies on this drawing without AECOM's express written consent. Do not scale this document.



CONSULTANT

AECOM House, 63-77 Victoria Street,
St. Albans, Hertfordshire, AL1 3ER
+44(0)1727 535000 tel
+44(0)1727 535099 fax
www.aecom.com

PROJECT

Sunnica Energy Farm

CLIENT



NOTE

1. THE TRAFFIC REGULATION MEASURES PLANS SHOULD BE READ IN CONJUNCTION WITH THE DEVELOPMENT CONSENT ORDER AND THE OTHER PLANS AND DOCUMENTS TO BE CERTIFIED BY IT, IN PARTICULAR ARTICLES 11 AND 44 OF, AND SCHEDULES 6 AND 14 TO, THE DEVELOPMENT CONSENT ORDER.
2. FURTHER INFORMATION IN RELATION TO PUBLIC RIGHTS OF WAY AND ACCESSES TO THE AUTHORISED DEVELOPMENT CAN BE FOUND ON THE ACCESS AND RIGHTS OF WAY PLANS.

KEY

- ORDER LIMITS
- PROPOSED TEMPORARY ROAD CLOSURE
- PROPOSED TEMPORARY ROAD CLOSURE (PUBLIC RIGHT OF WAY)

SHEET PLAN

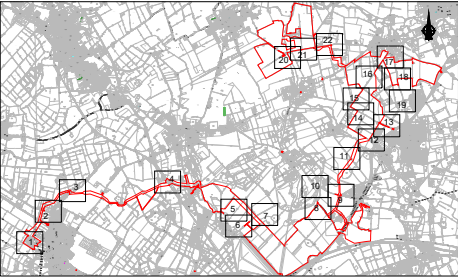

Document Reference: EN010106/APP/2.4

ISSUE/REVISION

2	11/11/2022	SUBMITTED AT DEADLINE 2
1	30/08/2022	CHANGE APPLICATION AUGUST 2022
0	18/11/2021	FOR DCO SUBMISSION
I/R	DATE	DESCRIPTION

SHEET TITLE

TRAFFIC REGULATION MEASURES PLANS -
TEMPORARY ROAD CLOSURES
INFRASTRUCTURE PLANNING
(APPLICATIONS: PRESCRIBED FORMS AND
PROCEDURE) REGULATIONS 2009 5(2)(O)
SHEET 8 OF 22

SHEET NUMBER

60589004-TRM-TRC-008

SCALE

1:2500 @ A3

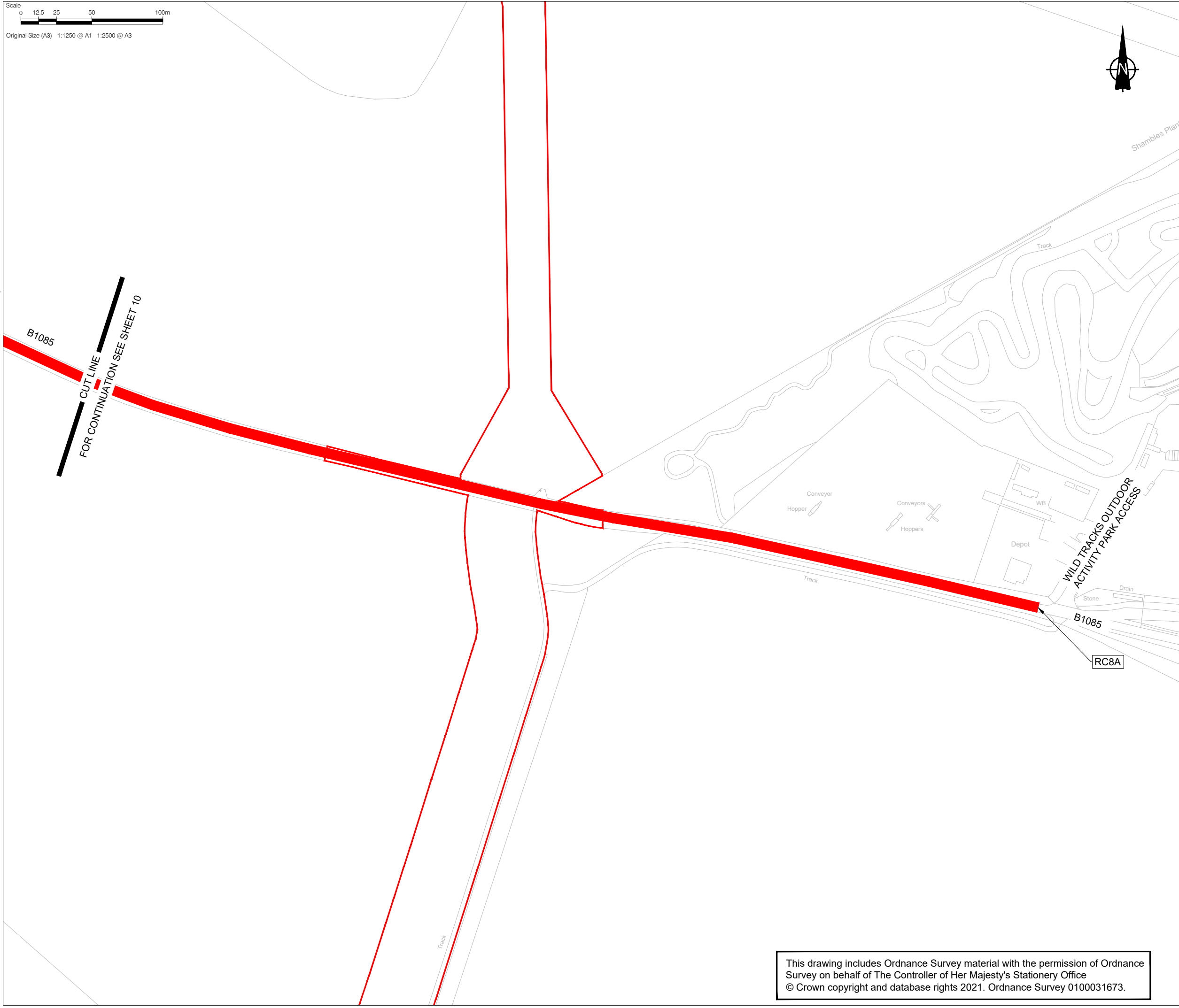

This drawing includes Ordnance Survey material with the permission of Ordnance Survey on behalf of The Controller of Her Majesty's Stationery Office
© Crown copyright and database rights 2021. Ordnance Survey 0100031673.

This drawing has been prepared for the use of AECOM's client. It may not be used, modified, reproduced or relied upon by third parties, except as agreed by AECOM or as required by law. AECOM accepts no responsibility, and denies any liability whatsoever, to any party that uses or relies on this drawing without AECOM's express written consent. Do not scale this document.



CONSULTANT

AECOM House, 63-77 Victoria Street,
St. Albans, Hertfordshire, AL1 3ER
+44(0)1727 535000 tel
+44(0)1727 535099 fax
www.aecom.com

PROJECT

Sunnica Energy Farm

CLIENT



NOTE

1. THE TRAFFIC REGULATION MEASURES PLANS SHOULD BE READ IN CONJUNCTION WITH THE DEVELOPMENT CONSENT ORDER AND THE OTHER PLANS AND DOCUMENTS TO BE CERTIFIED BY IT, IN PARTICULAR ARTICLES 11 AND 44 OF, AND SCHEDULES 6 AND 14 TO, THE DEVELOPMENT CONSENT ORDER.
2. FURTHER INFORMATION IN RELATION TO PUBLIC RIGHTS OF WAY AND ACCESSES TO THE AUTHORISED DEVELOPMENT CAN BE FOUND ON THE ACCESS AND RIGHTS OF WAY PLANS.

KEY

- ORDER LIMITS
- PROPOSED TEMPORARY ROAD CLOSURE
- PROPOSED TEMPORARY ROAD CLOSURE (PUBLIC RIGHT OF WAY)

SHEET PLAN

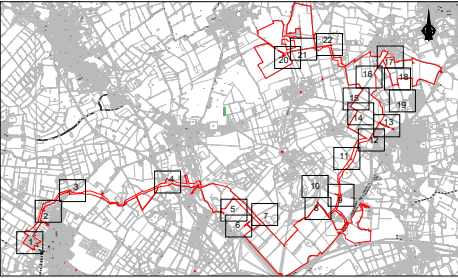

Document Reference: EN010106/APP/2.4

ISSUE/REVISION

2	11/11/2022	SUBMITTED AT DEADLINE 2
1	30/08/2022	CHANGE APPLICATION AUGUST 2022
0	18/11/2021	FOR DCO SUBMISSION
I/R	DATE	DESCRIPTION

SHEET TITLE

TRAFFIC REGULATION MEASURES PLANS -
TEMPORARY ROAD CLOSURES
INFRASTRUCTURE PLANNING
(APPLICATIONS: PRESCRIBED FORMS AND
PROCEDURE) REGULATIONS 2009 5(2)(O)
SHEET 9 OF 22

SHEET NUMBER

60589004-TRM-TRC-009

SCALE

1:2500 @ A3

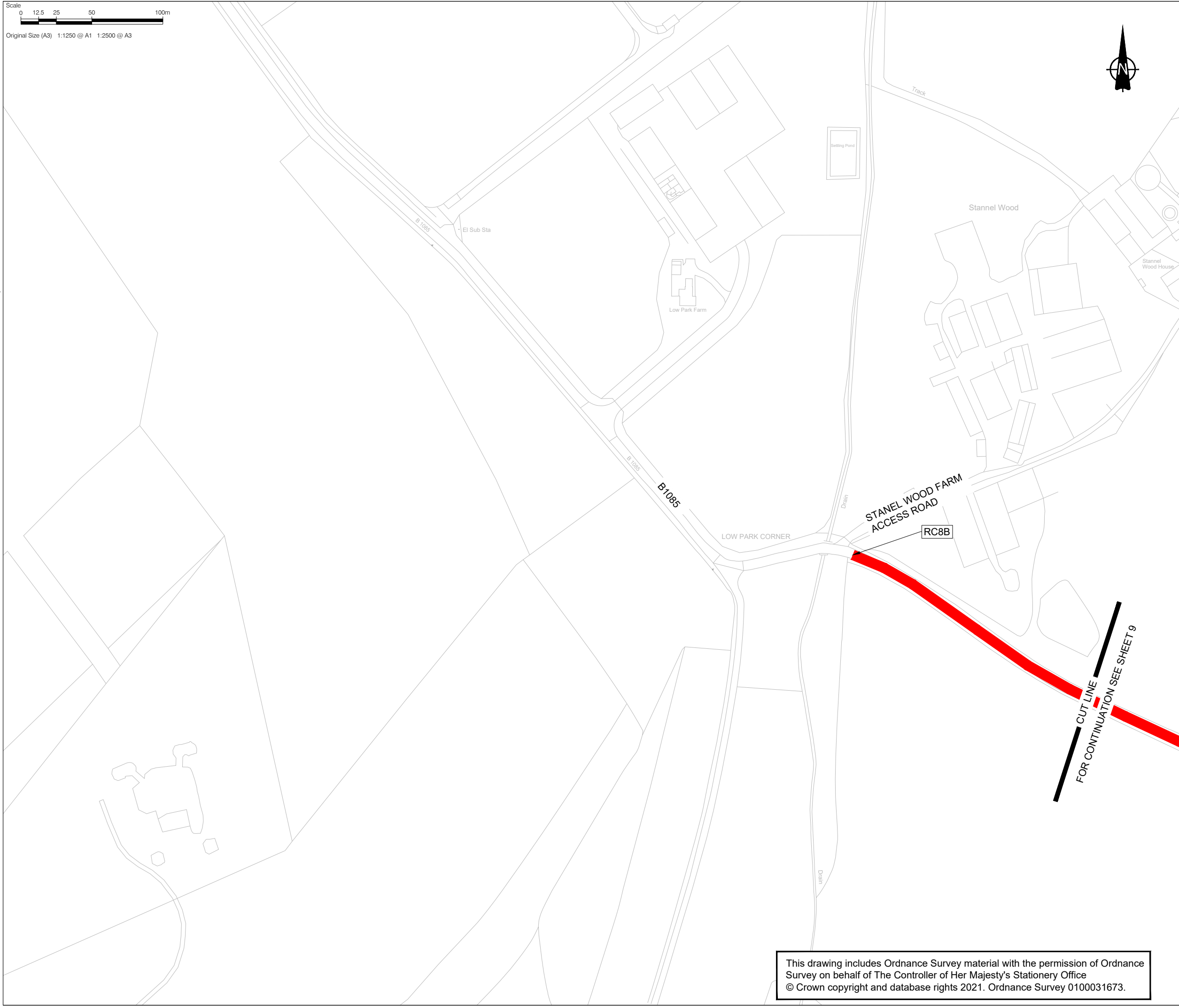

This drawing includes Ordnance Survey material with the permission of Ordnance Survey on behalf of The Controller of Her Majesty's Stationery Office
© Crown copyright and database rights 2021. Ordnance Survey 0100031673.

This drawing has been prepared for the use of AECOM's client. It may not be used, modified, reproduced or relied upon by third parties, except as agreed by AECOM or as required by law. AECOM accepts no responsibility, and denies any liability whatsoever, to any party that uses or relies on this drawing without AECOM's express written consent. Do not scale this document.



CONSULTANT

AECOM House, 63-77 Victoria Street,
St. Albans, Hertfordshire, AL1 3ER
+44(0)1727 535000 tel
+44(0)1727 535099 fax
www.aecom.com

PROJECT

Sunnica Energy Farm

CLIENT



NOTE

1. THE TRAFFIC REGULATION MEASURES PLANS SHOULD BE READ IN CONJUNCTION WITH THE DEVELOPMENT CONSENT ORDER AND THE OTHER PLANS AND DOCUMENTS TO BE CERTIFIED BY IT, IN PARTICULAR ARTICLES 11 AND 44 OF, AND SCHEDULES 6 AND 14 TO, THE DEVELOPMENT CONSENT ORDER.
2. FURTHER INFORMATION IN RELATION TO PUBLIC RIGHTS OF WAY AND ACCESSES TO THE AUTHORISED DEVELOPMENT CAN BE FOUND ON THE ACCESS AND RIGHTS OF WAY PLANS.

KEY

- ORDER LIMITS
- PROPOSED TEMPORARY ROAD CLOSURE
- PROPOSED TEMPORARY ROAD CLOSURE (PUBLIC RIGHT OF WAY)

SHEET PLAN

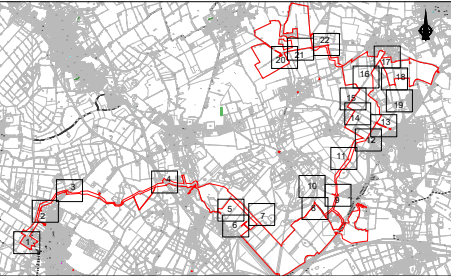

Document Reference: EN010106/APP/2.4

ISSUE/REVISION

2	11/11/2022	SUBMITTED AT DEADLINE 2
1	30/08/2022	CHANGE APPLICATION AUGUST 2022
0	18/11/2021	FOR DCO SUBMISSION
I/R	DATE	DESCRIPTION

SHEET TITLE

TRAFFIC REGULATION MEASURES PLANS -
TEMPORARY ROAD CLOSURES
INFRASTRUCTURE PLANNING
(APPLICATIONS: PRESCRIBED FORMS AND
PROCEDURE) REGULATIONS 2009 5(2)(O)
SHEET 10 OF 22

SHEET NUMBER

60589004-TRM-TRC-010

SCALE

1:2500 @ A3

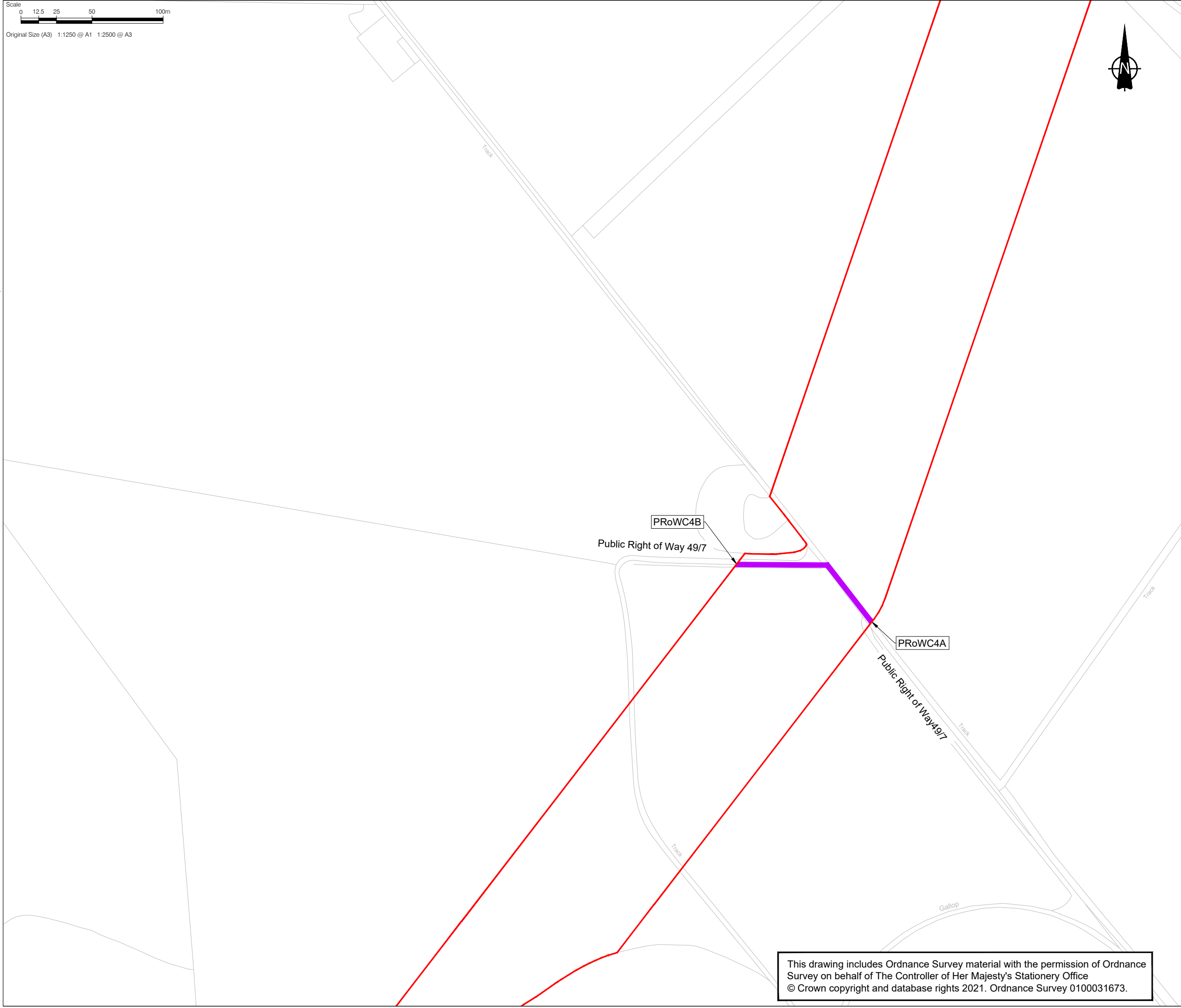

This drawing includes Ordnance Survey material with the permission of Ordnance Survey on behalf of The Controller of Her Majesty's Stationery Office
© Crown copyright and database rights 2021. Ordnance Survey 0100031673.

This drawing has been prepared for the use of AECOM's client. It may not be used, modified, reproduced or relied upon by third parties, except as agreed by AECOM or as required by law. AECOM accepts no responsibility, and denies any liability whatsoever, to any party that uses or relies on this drawing without AECOM's express written consent. Do not scale this document.



CONSULTANT

AECOM House, 63-77 Victoria Street,
St. Albans, Hertfordshire, AL1 3ER
+44(0)1727 535000 tel
+44(0)1727 535099 fax
www.aecom.com

PROJECT

Sunnica Energy Farm

CLIENT



NOTE

1. THE TRAFFIC REGULATION MEASURES PLANS SHOULD BE READ IN CONJUNCTION WITH THE DEVELOPMENT CONSENT ORDER AND THE OTHER PLANS AND DOCUMENTS TO BE CERTIFIED BY IT, IN PARTICULAR ARTICLES 11 AND 44 OF, AND SCHEDULES 6 AND 14 TO, THE DEVELOPMENT CONSENT ORDER.
2. FURTHER INFORMATION IN RELATION TO PUBLIC RIGHTS OF WAY AND ACCESSES TO THE AUTHORISED DEVELOPMENT CAN BE FOUND ON THE ACCESS AND RIGHTS OF WAY PLANS.

KEY

- ORDER LIMITS
- PROPOSED TEMPORARY ROAD CLOSURE
- PROPOSED TEMPORARY ROAD CLOSURE (PUBLIC RIGHT OF WAY)

SHEET PLAN

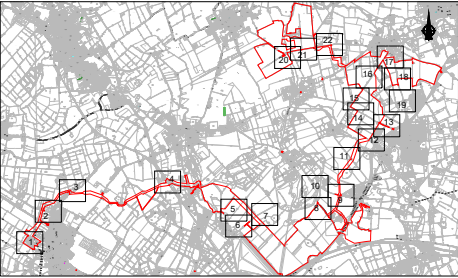

Document Reference: EN010106/APP/2.4

ISSUE/REVISION

2	11/11/2022	SUBMITTED AT DEADLINE 2
1	30/08/2022	CHANGE APPLICATION AUGUST 2022
0	18/11/2021	FOR DCO SUBMISSION
I/R	DATE	DESCRIPTION

SHEET TITLE

TRAFFIC REGULATION MEASURES PLANS -
TEMPORARY ROAD CLOSURES
INFRASTRUCTURE PLANNING
(APPLICATIONS: PRESCRIBED FORMS AND
PROCEDURE) REGULATIONS 2009 5(2)(O)
SHEET 11 OF 22

SHEET NUMBER

60589004-TRM-TRC-011

SCALE

1:2500 @ A3

Project Management Initials: Designer: DC Checked: CEC Approved: CC ISO A3 420mm x 297mm
Latest Revision Initials: Checked: 60589004
Project Reference Number: 60589004
Last saved by: HATONCM(2022-11-07) Last Plotted: 2022-11-07
Filename: \\NA.AECOM\NET\COM\FS\EN\EA\ST\ALBANS-UNST\1\LEGACY\0\PROJECTS\SUNNICA ENERGY FARMES APPLICATION\CAD\TROS2.WP1\TRAFFIC REGULATION MEASURES_SHEETS_TRC.DWG

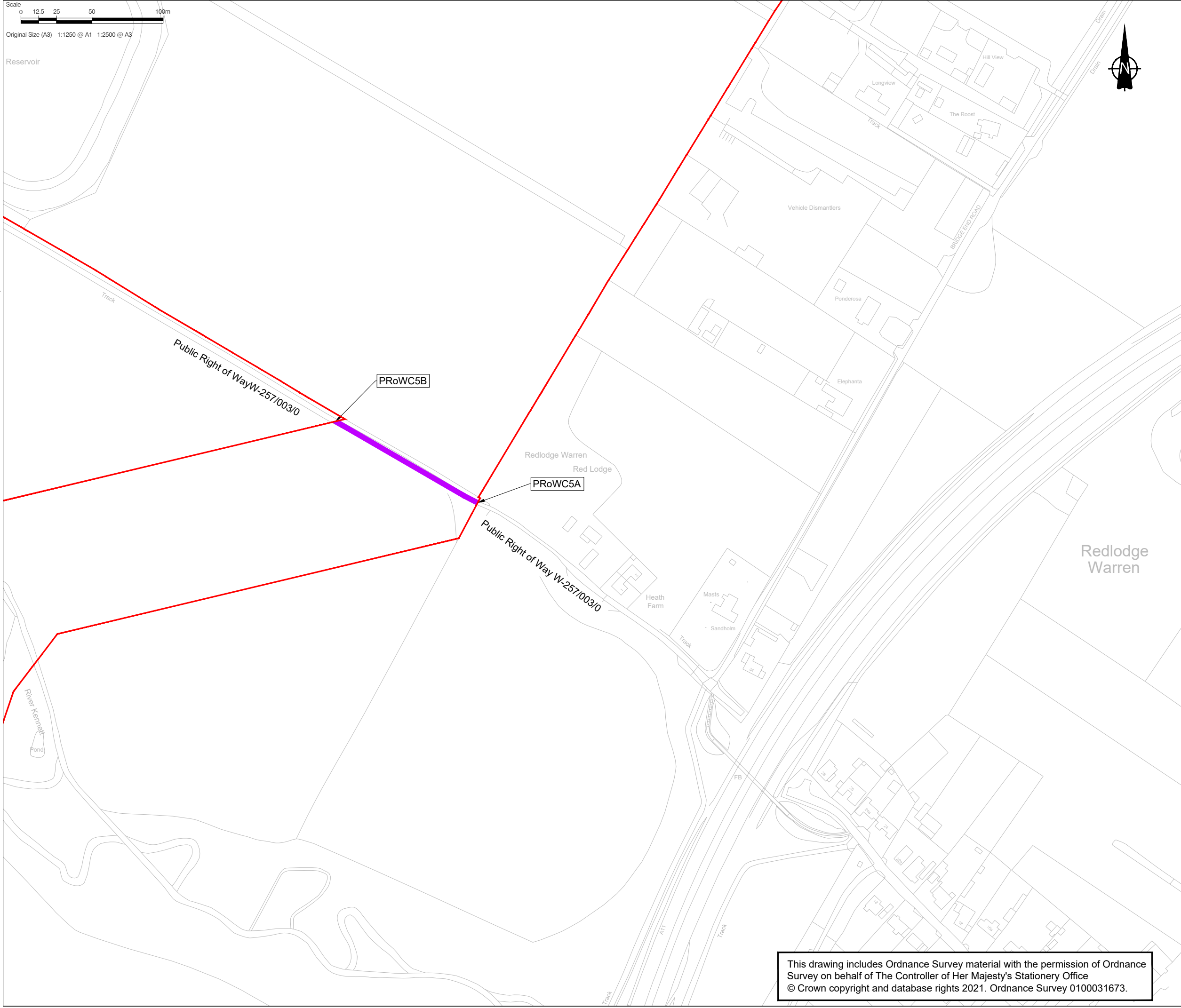

This drawing includes Ordnance Survey material with the permission of Ordnance Survey on behalf of The Controller of Her Majesty's Stationery Office
© Crown copyright and database rights 2021. Ordnance Survey 0100031673.

This drawing has been prepared for the use of AECOM's client. It may not be used, modified, reproduced or relied upon by third parties, except as agreed by AECOM or as required by law. AECOM accepts no responsibility, and denies any liability whatsoever, to any party that uses or relies on this drawing without AECOM's express written consent. Do not scale this document.



CONSULTANT

AECOM House, 63-77 Victoria Street,
St. Albans, Hertfordshire, AL1 3ER
+44(0)1727 535000 tel
+44(0)1727 535099 fax
www.aecom.com

PROJECT

Sunnica Energy Farm

CLIENT



NOTE

1. THE TRAFFIC REGULATION MEASURES PLANS SHOULD BE READ IN CONJUNCTION WITH THE DEVELOPMENT CONSENT ORDER AND THE OTHER PLANS AND DOCUMENTS TO BE CERTIFIED BY IT, IN PARTICULAR ARTICLES 11 AND 44 OF, AND SCHEDULES 6 AND 14 TO, THE DEVELOPMENT CONSENT ORDER.
2. FURTHER INFORMATION IN RELATION TO PUBLIC RIGHTS OF WAY AND ACCESSES TO THE AUTHORISED DEVELOPMENT CAN BE FOUND ON THE ACCESS AND RIGHTS OF WAY PLANS.

KEY

- ORDER LIMITS
- PROPOSED TEMPORARY ROAD CLOSURE
- PROPOSED TEMPORARY ROAD CLOSURE (PUBLIC RIGHT OF WAY)

SHEET PLAN

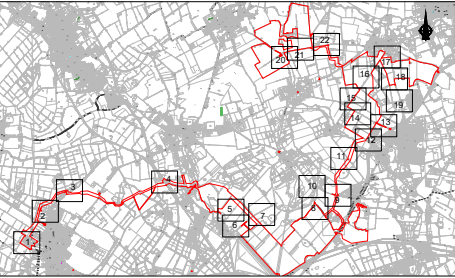

Document Reference: EN010106/APP/2.4
ISSUE/REVISION

2	11/11/2022	SUBMITTED AT DEADLINE 2
1	30/08/2022	CHANGE APPLICATION AUGUST 2022
0	18/11/2021	FOR DCO SUBMISSION
I/R	DATE	DESCRIPTION

SHEET TITLE

TRAFFIC REGULATION MEASURES PLANS -
TEMPORARY ROAD CLOSURES
INFRASTRUCTURE PLANNING
(APPLICATIONS: PRESCRIBED FORMS AND
PROCEDURE) REGULATIONS 2009 5(2)(O)
SHEET 12 OF 22

SHEET NUMBER

60589004-TRM-TRC-012

SCALE

1:2500 @ A3

Project Management Initials: Designer: DC Checked: CEC Approved: CC ISO A3 420mm x 297mm
Latest Revision Initials: Checked: 60589004
Project Reference Number: 60589004

Last saved by: HATONCM(2022-11-07) Last Plotted: 2022-11-07
Filename: \\NA.AECOM\NET\COM\FSE\ENEA\STALBANS\UNST\1\LEGACY\PROJECTS\SUNNICA ENERGY FARMES APPLICATION\CA\TROS2.WIP\TRAFFIC REGULATION MEASURES_SHEETS_TRC.DWG

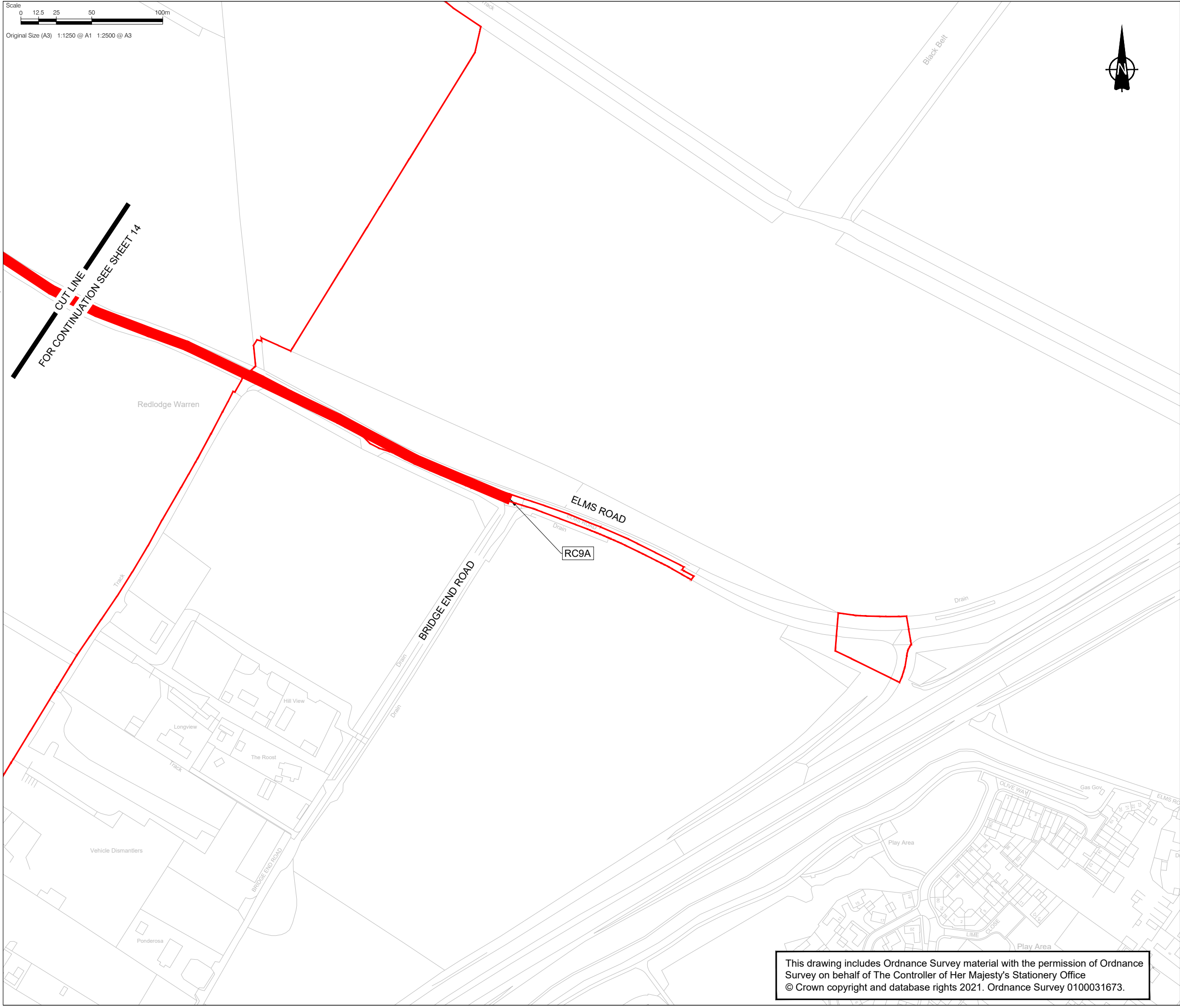

This drawing includes Ordnance Survey material with the permission of Ordnance Survey on behalf of The Controller of Her Majesty's Stationery Office
© Crown copyright and database rights 2021. Ordnance Survey 0100031673.

This drawing has been prepared for the use of AECOM's client. It may not be used, modified, reproduced or relied upon by third parties, except as agreed by AECOM or as required by law. AECOM accepts no responsibility, and denies any liability whatsoever, to any party that uses or relies on this drawing without AECOM's express written consent. Do not scale this document.



CONSULTANT

AECOM House, 63-77 Victoria Street,
St. Albans, Hertfordshire, AL1 3ER
+44(0)1727 535000 tel
+44(0)1727 535099 fax
www.aecom.com

PROJECT

Sunnica Energy Farm

CLIENT



NOTE

1. THE TRAFFIC REGULATION MEASURES PLANS SHOULD BE READ IN CONJUNCTION WITH THE DEVELOPMENT CONSENT ORDER AND THE OTHER PLANS AND DOCUMENTS TO BE CERTIFIED BY IT, IN PARTICULAR ARTICLES 11 AND 44 OF, AND SCHEDULES 6 AND 14 TO, THE DEVELOPMENT CONSENT ORDER.
2. FURTHER INFORMATION IN RELATION TO PUBLIC RIGHTS OF WAY AND ACCESSES TO THE AUTHORISED DEVELOPMENT CAN BE FOUND ON THE ACCESS AND RIGHTS OF WAY PLANS.

KEY

- ORDER LIMITS
- PROPOSED TEMPORARY ROAD CLOSURE
- PROPOSED TEMPORARY ROAD CLOSURE (PUBLIC RIGHT OF WAY)

SHEET PLAN

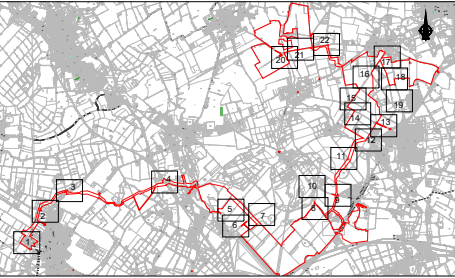

Document Reference: EN010106/APP/2.4

ISSUE/REVISION

2	11/11/2022	SUBMITTED AT DEADLINE 2
1	30/08/2022	CHANGE APPLICATION AUGUST 2022
0	18/11/2021	FOR DCO SUBMISSION
I/R	DATE	DESCRIPTION

SHEET TITLE

TRAFFIC REGULATION MEASURES PLANS -
TEMPORARY ROAD CLOSURES
INFRASTRUCTURE PLANNING
(APPLICATIONS: PRESCRIBED FORMS AND
PROCEDURE) REGULATIONS 2009 5(2)(O)
SHEET 13 OF 22

SHEET NUMBER

60589004-TRM-TRC-013

SCALE

1:2500 @ A3

Project Management Initials: Designer: DC Checked: CEC Approved: CC ISO A3 420mm x 297mm
Latest Revision Initials: Checked: Approved: 60589004
Project Reference Number: 60589004
Last saved by: HATONCM(2022-11-07) Last Plotted: 2022-11-07
Filename: \\NA.AECOM\NET\COM\FS\EN\EA\ST\ALBANS-UNST\1\LEGACY\0\PROJECTS\SUNNICA ENERGY FARMES APPLICATION\CA\T\ROS2.WP\TRAFFIC REGULATION MEASURES_S\SHEETS_TRC.DWG

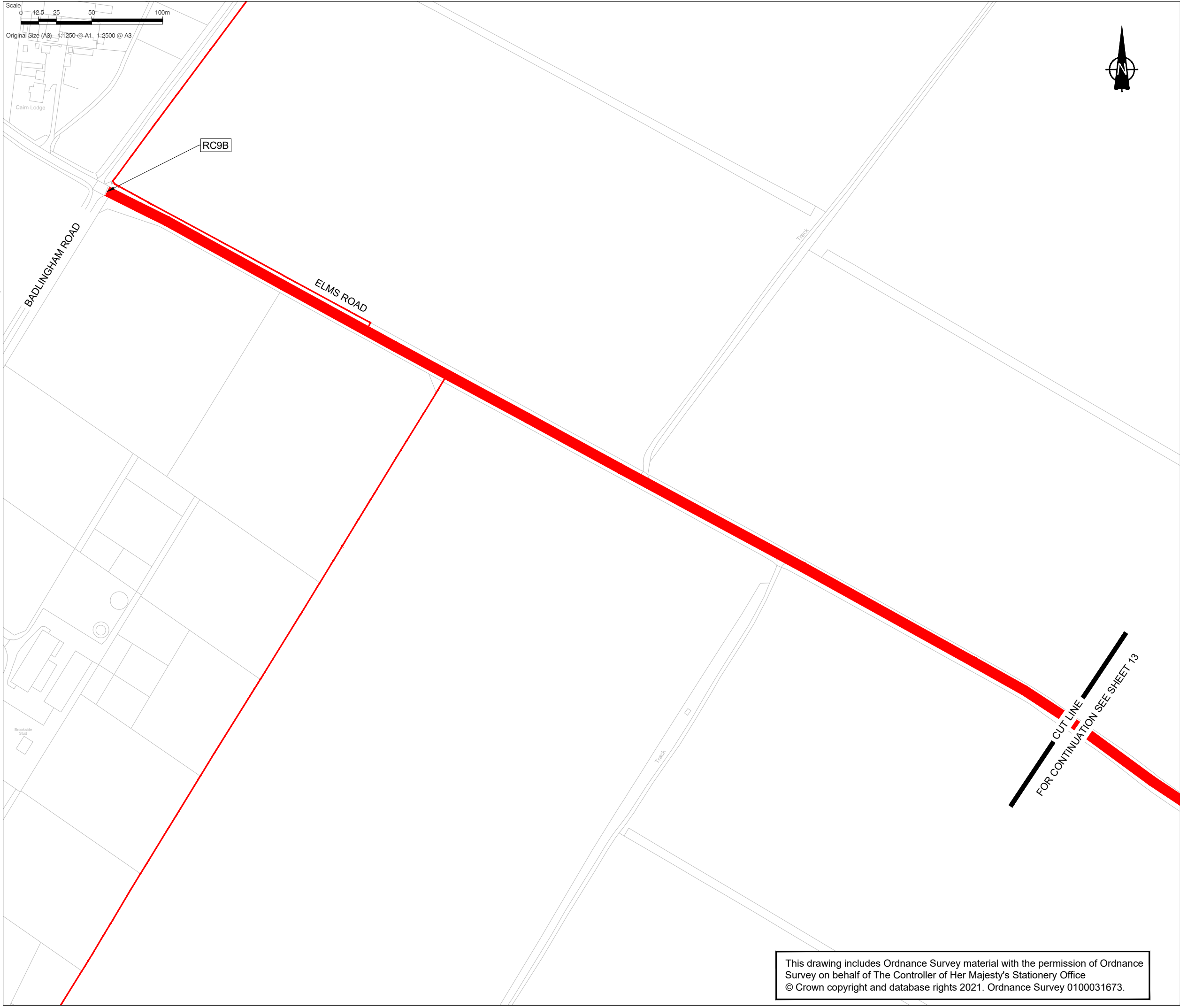

This drawing includes Ordnance Survey material with the permission of Ordnance Survey on behalf of The Controller of Her Majesty's Stationery Office
© Crown copyright and database rights 2021. Ordnance Survey 0100031673.

This drawing has been prepared for the use of AECOM's client. It may not be used, modified, reproduced or relied upon by third parties, except as agreed by AECOM or as required by law. AECOM accepts no responsibility, and denies any liability whatsoever, to any party that uses or relies on this drawing without AECOM's express written consent. Do not scale this document.



CONSULTANT

AECOM House, 63-77 Victoria Street,
St. Albans, Hertfordshire, AL1 3ER
+44(0)1727 535000 tel
+44(0)1727 535099 fax
www.aecom.com

PROJECT

Sunnica Energy Farm

CLIENT



NOTE

1. THE TRAFFIC REGULATION MEASURES PLANS SHOULD BE READ IN CONJUNCTION WITH THE DEVELOPMENT CONSENT ORDER AND THE OTHER PLANS AND DOCUMENTS TO BE CERTIFIED BY IT, IN PARTICULAR ARTICLES 11 AND 44 OF, AND SCHEDULES 6 AND 14 TO, THE DEVELOPMENT CONSENT ORDER.
2. FURTHER INFORMATION IN RELATION TO PUBLIC RIGHTS OF WAY AND ACCESSES TO THE AUTHORISED DEVELOPMENT CAN BE FOUND ON THE ACCESS AND RIGHTS OF WAY PLANS.

KEY

- ORDER LIMITS
- PROPOSED TEMPORARY ROAD CLOSURE
- PROPOSED TEMPORARY ROAD CLOSURE (PUBLIC RIGHT OF WAY)

SHEET PLAN

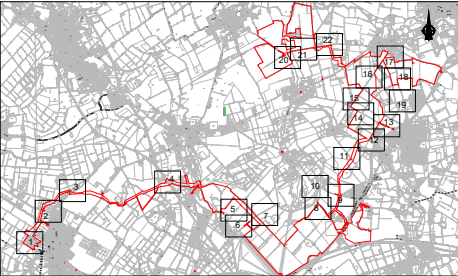

Document Reference: EN010106/APP/2.4

ISSUE/REVISION

2	11/11/2022	SUBMITTED AT DEADLINE 2
1	30/08/2022	CHANGE APPLICATION AUGUST 2022
0	18/11/2021	FOR DCO SUBMISSION
I/R	DATE	DESCRIPTION

SHEET TITLE

TRAFFIC REGULATION MEASURES PLANS -
TEMPORARY ROAD CLOSURES
INFRASTRUCTURE PLANNING
(APPLICATIONS: PRESCRIBED FORMS AND
PROCEDURE) REGULATIONS 2009 5(2)(O)
SHEET 14 OF 22

SHEET NUMBER

60589004-TRM-TRC-014

SCALE

1:2500 @ A3